

Musikens Hus

RIDER: Small Venue Café/Restaurant

PA:

3-way system with 20-channel mixer and 2-channel monitor system

Mixer:

Alto L-20, 20-4-2. with 4 Aux send, digital effects, 9-band main EQ, 3-band EQ on every channel. 14 microphone input, 2 mic-/line and 4 stereo line + connection for external tape, CD etc.

Cross over:

Martin, active two way split.

FX:

24-bit Alto digital effect , 1 x TC. M-One Multi effect

Main Speakers:

3-way speaker system with 2 x Wave 15" (Lo) och 4 x Cerwin Vega PS10 10"-1"

Main amps 2 x LAB 1000.

Monitor Speakers:

4 x 12 Ciare coax wedge

Monitor amp Alto Mac 2.2

2 system with separate 32 band EQ

Microphones & D.I:s

Microphones: 7 x SM-58 and 5 x SM-57 + 4 DI-box Line Stage + 2 ART Tubeamp.

TSM drum case: 1 x MT-51, 4 x MT-56, 2 x MT-81 cond. mic

Lights & Lamps

Stage:

4 Par 56 led

4 Spot led

Powered by Showtec Easy 16

2 Water effect H2O rgb on backdrop.

Floor/Ambient:

Mirrorball, pinspots, colourchanger

4 disco effects

Projector (optional, on request)

Smokemachine (optional on request)

Dimensions:

Stage room: 7,5m x 9,2m

Café room: 7,5m x 5,9m.

Black room: 5,5m x 5m

Stage dimension:

2,5m x 2,6m, roof height: 2,3m

Audience:

Café/Restaurant is allowed for 150 persons

Date: 2018-09-19	
Venue: Small Venue	
Sketch type: Technical equipment, dimensions	
Musikens Hus Gothenburg	

LIGHT & CONTROLLER

Controlled by Showtec Easy. DMX:

- 1-4 (2) Par 56 led
- 4 (2) Par 56 led
- 9-12 (4) Spot led

Controlled by Switch:

- 2 Babystar
- 2 Discolight

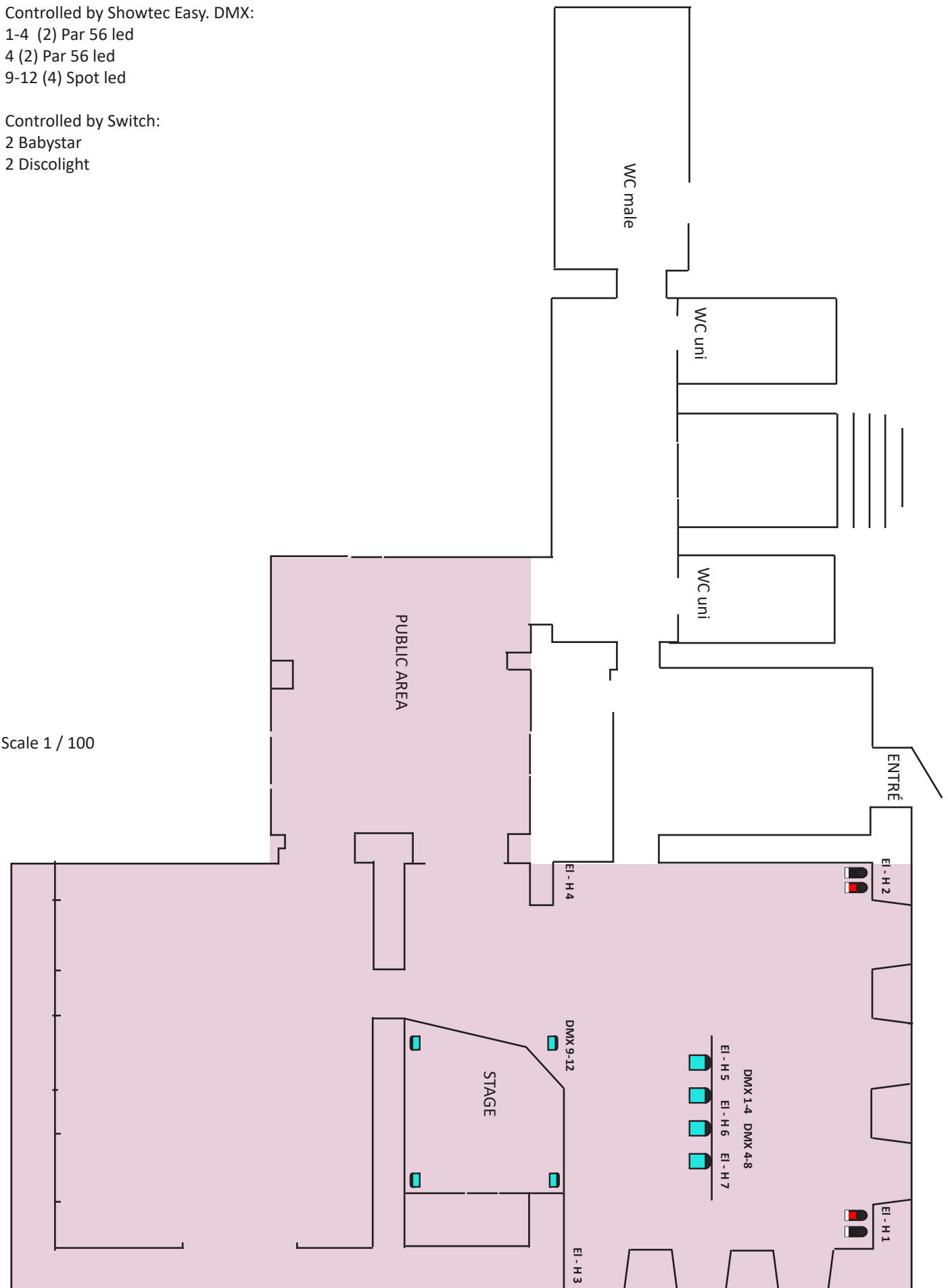

Scale 1 / 100